



EDGE Automation

## LEVELING CASTORS



Mahadev Vadi Main Road, Laxminagar,  
Opp. Tatkalik Hanuman Chowk,  
Rajkot - 360004, Gujarat (India)  
Lan. Office : 0281-2372466



Plot No.2/3, Survey No. 30/1,  
B/h. Ganga Forging,  
Shapar - 360024, (Rajkot)



+91 94260 75914, +91 94261 75914



[sales@edgeautomation.co.in](mailto:sales@edgeautomation.co.in)

## JDF-40F

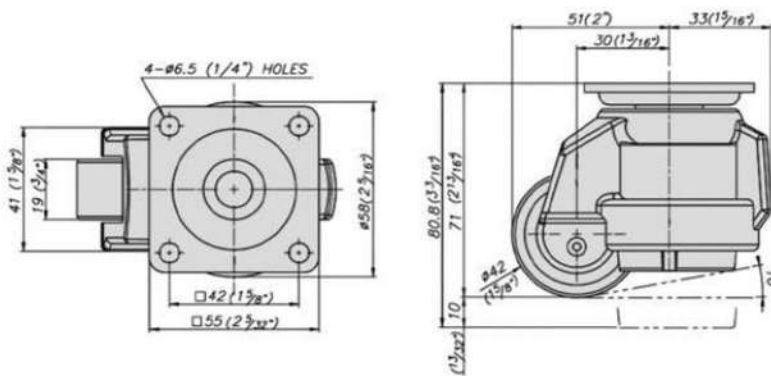

### PRODUCT DESCRIPTION

- 1) top plate : Pressed steel plate
- 2) frame : Al die- casting frame
- 3) handle : ABS resin handle
- 4) leveling pad : NBR resin cushion
- 5) wheel : PC + GF resin wheel
- 6) finish : powder coated & zinc galvanized

### SELECT ITEMS

- variety of cushion available
- Black finish is available

### SPEC ( °C/mm/kg )

Wheel Diameter	42 mm
Width of Tread	20 mm
Hardness of Tread	70S shore D
Size of Plate	55 × 55 mm
Plate Hole Centers	42 × 42 mm
Plate Hole	6.5 mm
Leveling Extent	10 mm
Offset	30 mm
Overall Height	71 mm
Load Capacity / 1 pcs	50 kg
Load Capacity / 4 pcs	100 kg

## JDF-40S

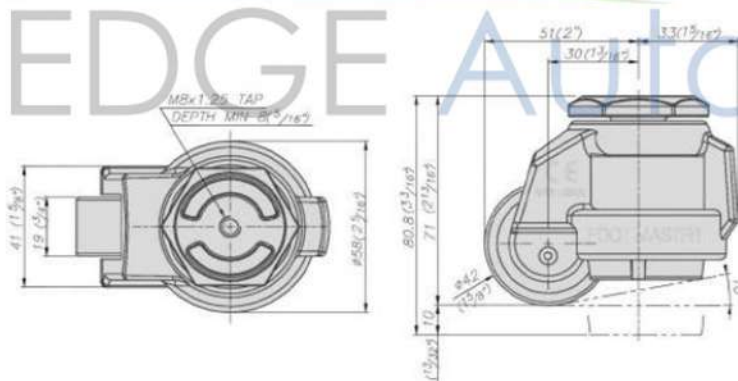

### PRODUCT DESCRIPTION

- 1) top plate : Pressed steel plate
- 2) frame : Al diecasted
- 3) handle : ABS resin handle
- 4) leveling pad : NBR resin cushion
- 5) wheel : nylon6
- 6) finish : powder coated & zinc galvanized

### SELECT ITEMS

- variety of cushion available
- Black finish is available

### SPEC ( °C/mm/kg )

Wheel Diameter	42 mm
Width of Tread	20 mm
Hardness of Tread	70 Shore D
Center Bolt	m8
Bolt Length	35 mm
Leveling Extent	10 mm
Offset	30 mm
Overall Height	71 mm
Load Capacity / 1 pcs	50 kg
Load Capacity / 4 pcs	100 kg



## JDF-60F

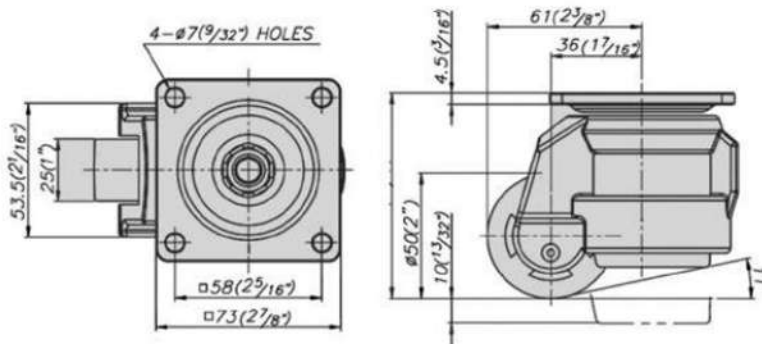

### PRODUCT DESCRIPTION

- 1) top plate : Pressed steel plate
- 2) frame : Al diecasted
- 3) handle : ABS resin handle
- 4) leveling pad : NBR resin cushion
- 5) wheel : nylon6
- 6) finish : powder coated & zinc galvanized

### SELECT ITEMS

- variety of cushion available
- Antistatic polyurethane wheels
- Black finish is available

### SPEC ( °C/mm/kg )

Wheel Diameter	50 mm
Width of Tread	25 mm
Hardness of Tread	70 Shore D
Size of Plate	73 x 73 mm
Plate Hole Centers	58 x 58 mm
Plate Hole	7 or 8.5 mm
Leveling Extent	10 mm
Offset	36 mm
Overall Height	82 mm
Load Capacity / 1 pcs	250 kg
Load Capacity / 4 pcs	500 kg

## JDF-60S

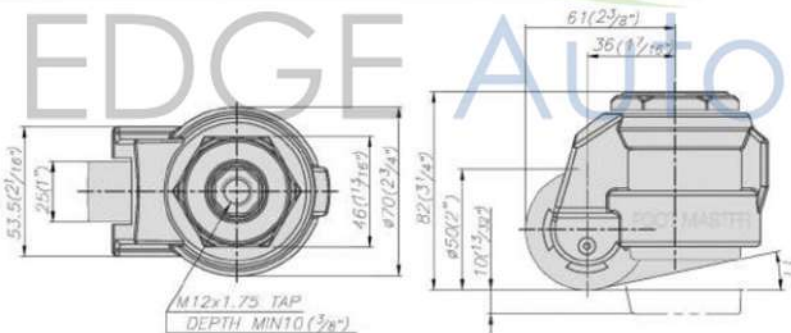

### PRODUCT DESCRIPTION

- 1) top plate : Pressed steel plate
- 2) frame : Al diecasted
- 3) handle : ABS resin handle
- 4) leveling pad : NBR resin cushion
- 5) wheel : nylon6
- 6) finish : power coated & zinc galvanized

### SELECT ITEMS

- variety of cushion available
- Antistatic polyurethane wheels
- Black finish is available

### SPEC ( °C/mm/kg )

Wheel Diameter	50 mm
Width of Tread	25 mm
Hardness of Tread	70 Shore D
Center Bolt	m12
Bolt Length	35 mm
Leveling Extent	10 mm
Offset	36 mm
Overall Height	82 mm
Load Capacity / 1 pcs	250 kg
Load Capacity / 4 pcs	500 kg

# JDF-80F

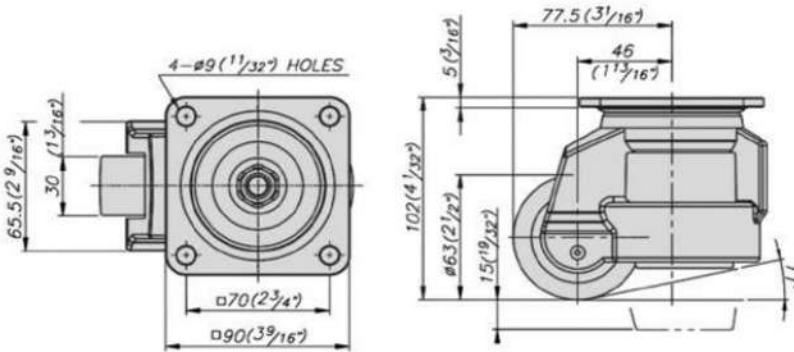

## PRODUCT DESCRIPTION

- 1) top plate : Pressed steel plate
- 2) frame : Al diecasted
- 3) handle : ABS resin handle
- 4) leveling pad : NBR resin cushion
- 5) wheel : nylon6
- 6) finish : powder coated & zinc galvanized

## SELECT ITEMS

- variety of cushion available
- Antistatic polyurethane wheels
- Black finish is available

## SPEC ( °C/mm/kg )

Wheel Diameter	63 mm
Width of Tread	30 mm
Hardness of Tread	70S hore D
Size of Plate	90 x 90 mm
Plate Hole Centers	70 x 70 mm
Plate Hole	9 mm
Leveling Extent	15 mm
Offset	46 mm
Overall Height	103 mm
Load Capacity / 1 pcs	500 kg
Load Capacity / 4pcs	1000 kg

# JDF-80S

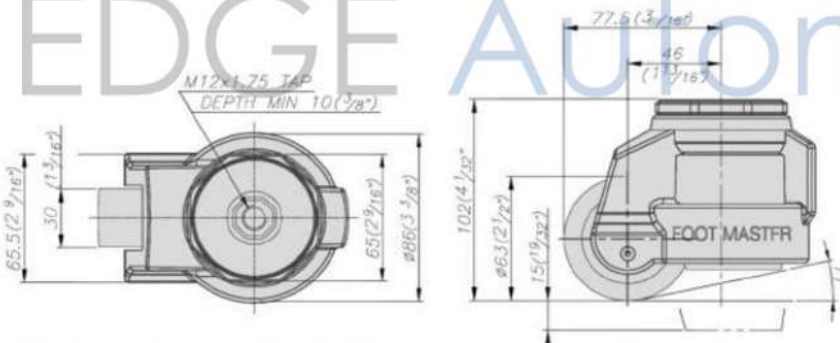

## PRODUCT DESCRIPTION

- 1) top plate : Pressed steel plate
- 2) frame : Al diecasted
- 3) handle : ABS resin handle
- 4) leveling pad : NBR resin cushion
- 5) wheel : nylon6
- 6) finish : power coated & zinc galvanized

## SELECT ITEMS

- variety of cushion available
- Antistatic polyurethane wheels
- Black finish is available

## SPEC ( °C/mm/kg )

Wheel Diameter	63 mm
Width of Tread	30 mm
Hardness of Tread	70 Shore D
Center Bolt	m12
Bolt Length	35 mm
Leveling Extent	15 mm
Offset	46 mm
Overall Height	103 mm
Load Capacity / 1 pcs	500 kg
Load Capacity / 4pcs	1000 kg



## JDF-100F

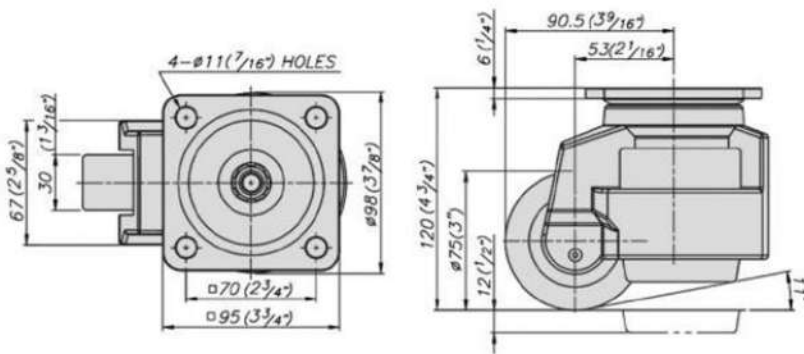

### PRODUCT DESCRIPTION

- 1) top plate : Pressed steel plate
- 2) frame : Al diecasted
- 3) handle : ABS resin handle
- 4) leveling pad : NBR resin cushion
- 5) wheel : nylon6
- 6) finish : powder coated & zinc galvanized

### SELECT ITEMS

- variety of cushion available
- Antistatic polyurethane wheels
- Black finish is available

### SPEC ( °C/mm/kg )

Wheel Diameter	75 mm
Width of Tread	30 mm
Hardness of Tread	70S hore D
Size of Plate	95 x 95 mm
Plate Hole Centers	70 x 70 mm
Plate Hole	11 mm
Leveling Extent	12 mm
Offset	53 mm
Overall Height	120 mm
Load Capacity / 1 pcs	750 kg
Load Capacity / 4pcs	1500 kg

## JDF-100S

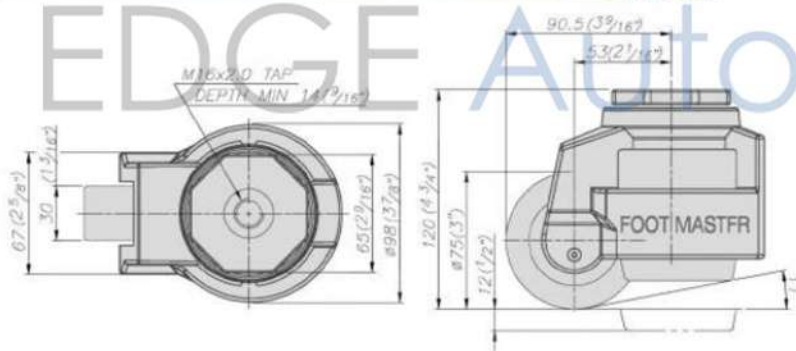

### PRODUCT DESCRIPTION

- 1) top plate : Pressed steel plate
- 2) frame : Al diecasted
- 3) handle : ABS resin handle
- 4) leveling pad : NBR resin cushion
- 5) wheel : nylon6
- 6) finish : powder coated & zinc galvanized

### SELECT ITEMS

- variety of cushion available
- Antistatic polyurethane wheels
- Black finish is available

### SPEC ( °C/mm/kg )

Wheel Diameter	75 mm
Width of Tread	30 mm
Hardness of Tread	70 Shore D
Center Bolt	m16
Bolt Length	35 mm
Leveling Extent	12 mm
Offset	53 mm
Overall Height	120 mm
Load Capacity / 1 pcs	750 kg
Load Capacity / 4pcs	1500 kg

## JDF-120F

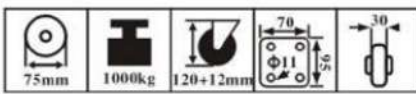
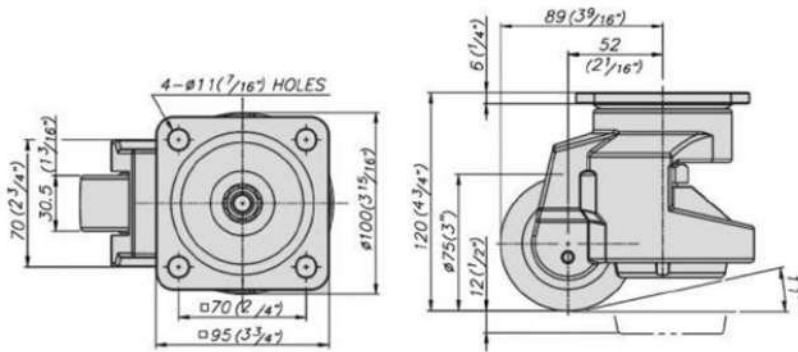

### PRODUCT DESCRIPTION

- 1) top plate : Pressed steel plate
- 2) frame : Al diecasted
- 3) handle : Carbon steel
- 4) leveling pad : Al die-casting frame
- 5) wheel : nylon6
- 6) finish : powder coated & zinc galvanized

### SELECT ITEMS

- Black finish is available

### SPEC ( °C/mm/kg )

Wheel Diameter	75 mm
Width of Tread	30 mm
Hardness of Tread	70S hore D
Size of Plate	95 × 95 mm
Plate Hole Centers	70 × 70 mm
Plate Hole	11 mm
Leveling Extent	12 mm
Offset	52 mm
Overall Height	120 mm
Load Capacity / 1 pcs	1000 kg
Load Capacity / 4 pcs	2000 kg

## JDF-120S

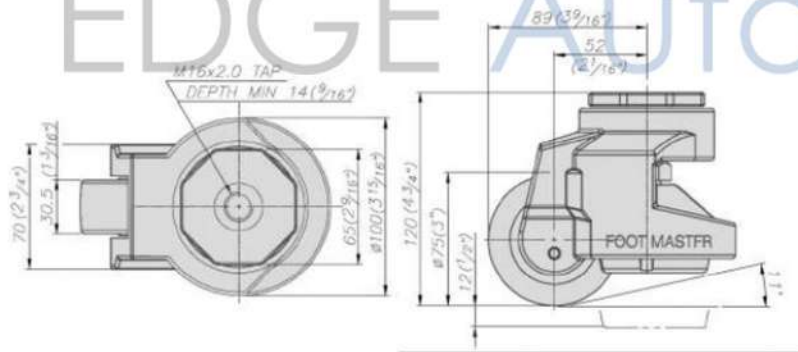

### PRODUCT DESCRIPTION

- 1) top plate : Pressed steel plate
- 2) frame : Al diecasted
- 3) handle : Carbon steel
- 4) leveling pad : Al die-casting frame
- 5) wheel : nylon6
- 6) finish : powder coated & zinc galvanized

### SELECT ITEMS

- Black finish is available

### SPEC ( °C/mm/kg )

Wheel Diameter	75 mm
Width of Tread	30 mm
Hardness of Tread	70S hore D
Center Bolt	m16
Bolt Length	35 mm
Leveling Extent	12 mm
Offset	52 mm
Overall Height	120 mm
Load Capacity / 1 pcs	1000 kg
Load Capacity / 4 pcs	2000 kg



# JDF-150F



## PRODUCT DESCRIPTION

- 1) top plate : Pressed steel plate
- 2) frame : Al diecasted
- 3) handle : Carbon steel
- 4) leveling pad : Al die-casting frame
- 5) wheel : MC nylon
- 6) finish : powder coated & zinc galvanized

## SELECT ITEMS

- Black finish is available

## SPEC ( °C/mm/kg )

Wheel Diameter	96 mm
Width of Tread	56 mm
Hardness of Tread	70S hore D
Size of Plate	100 × 100 mm
Plate Hole Centers	70 × 70 mm
Plate Hole	13 mm
Leveling Extent	15 mm
Offset	69 mm
Overall Height	132 mm
Load Capacity / 1 pcs	1500 kg
Load Capacity / 4pcs	3000 kg



# EDGE Automation

